

# Conceptual Design of Optical Table Cover for TRX and TRY

Yuta Michimura

Department of Physics, University of Tokyo

# Overview

- See [JGW-T1910129](#), [JGW-D1910377](#) and [JGW-D1910654](#) for the basic design
- TRX and TRY covers are similar to those but the size of the optical table is different
- Also, at TRX and TRY, green beam coming out of the TMS chamber have completely different optical path from IR, so the design of the tube is different
- TRX and TRY have the same design

# Optical Layout

[JGW-T1808962](#)

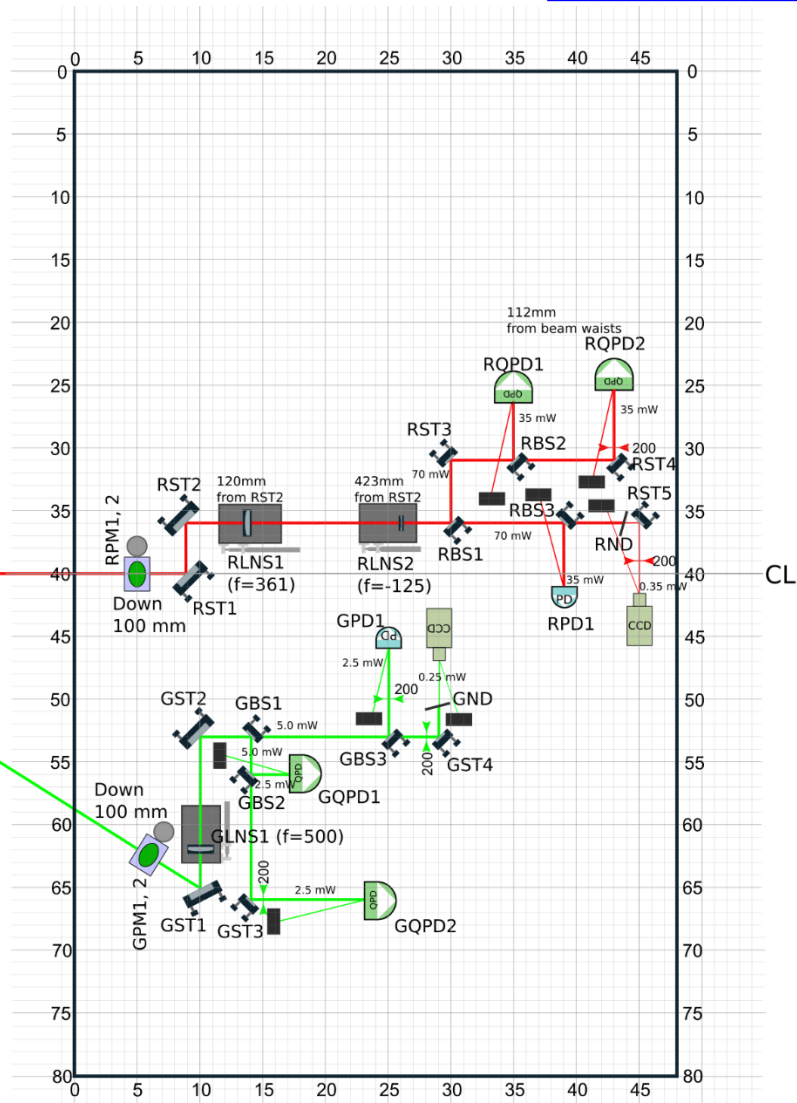
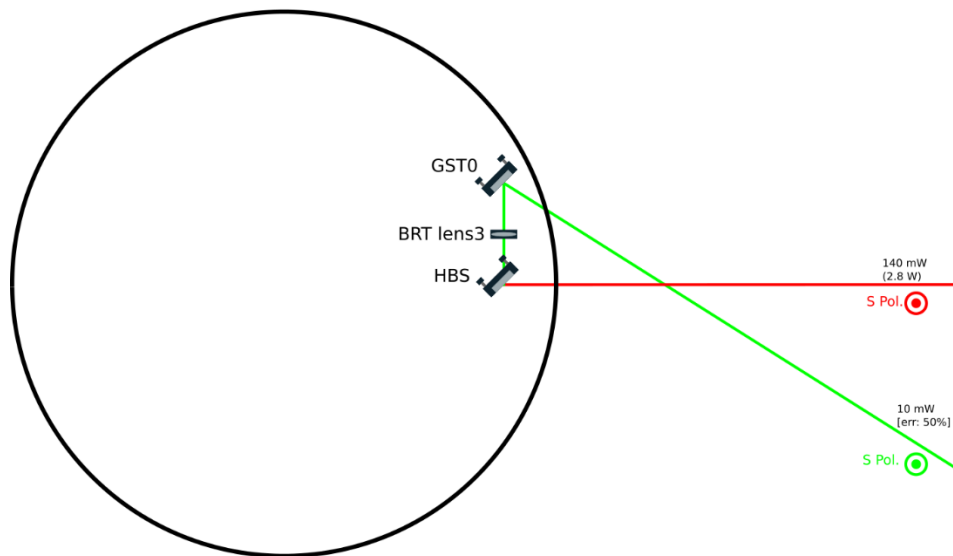

CL

# Size of the Tube

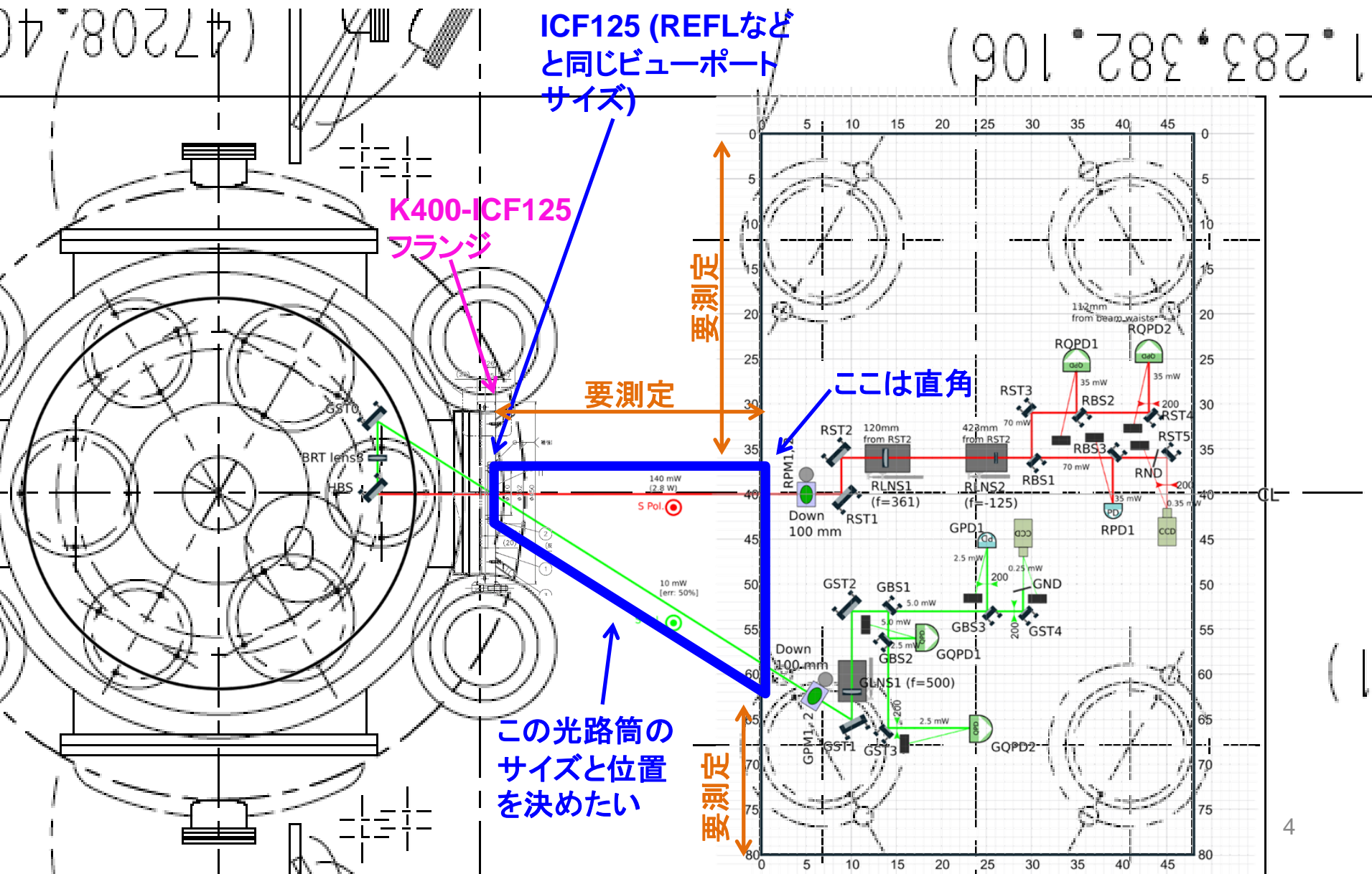

# Lengths from Drawings

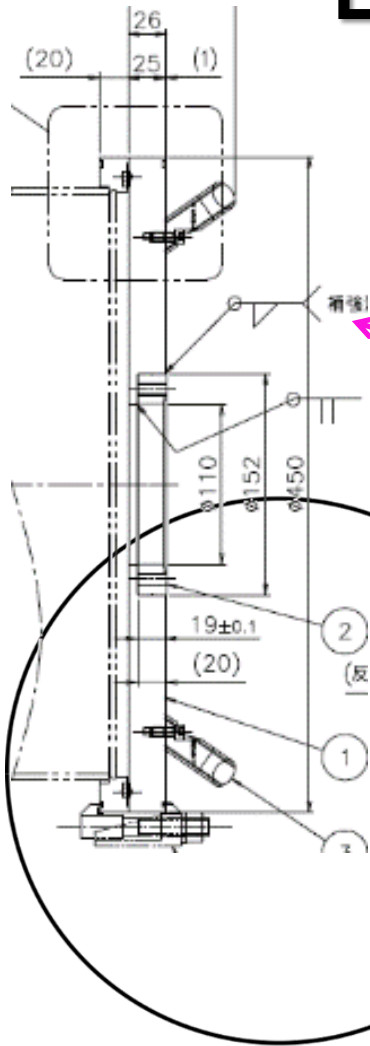

K400-ICF125フランジの表面から  
光学定盤端面まで

K400-ICF125  
フランジ

735 mm

924 mm

光学定盤の中心まで1000  
からICF152の半分を引いたもの  
 $1000 - 152/2 = 924$

光学定盤端面からGreenまでの距離  
525からICF152の半分を引いたもの  
 $525 - 152/2 = 449$

449 mm

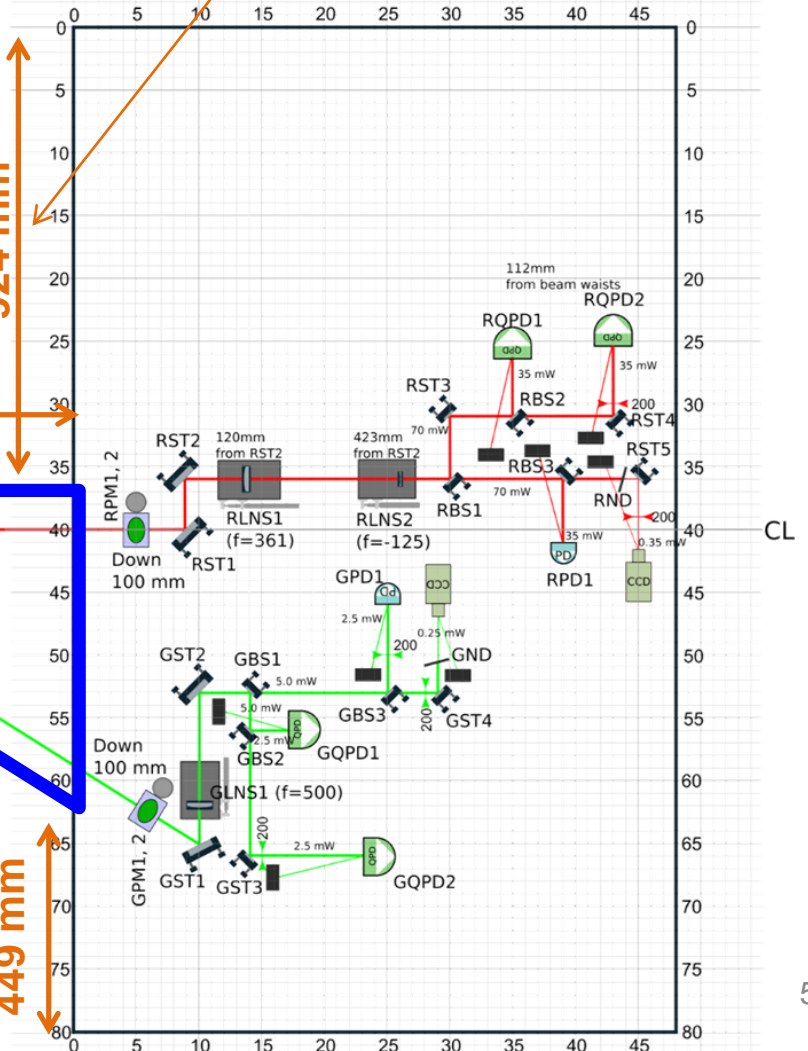

# Tube Position and Cover Size

図面上の長さをもとに、  
キリの良い数字にしたもの

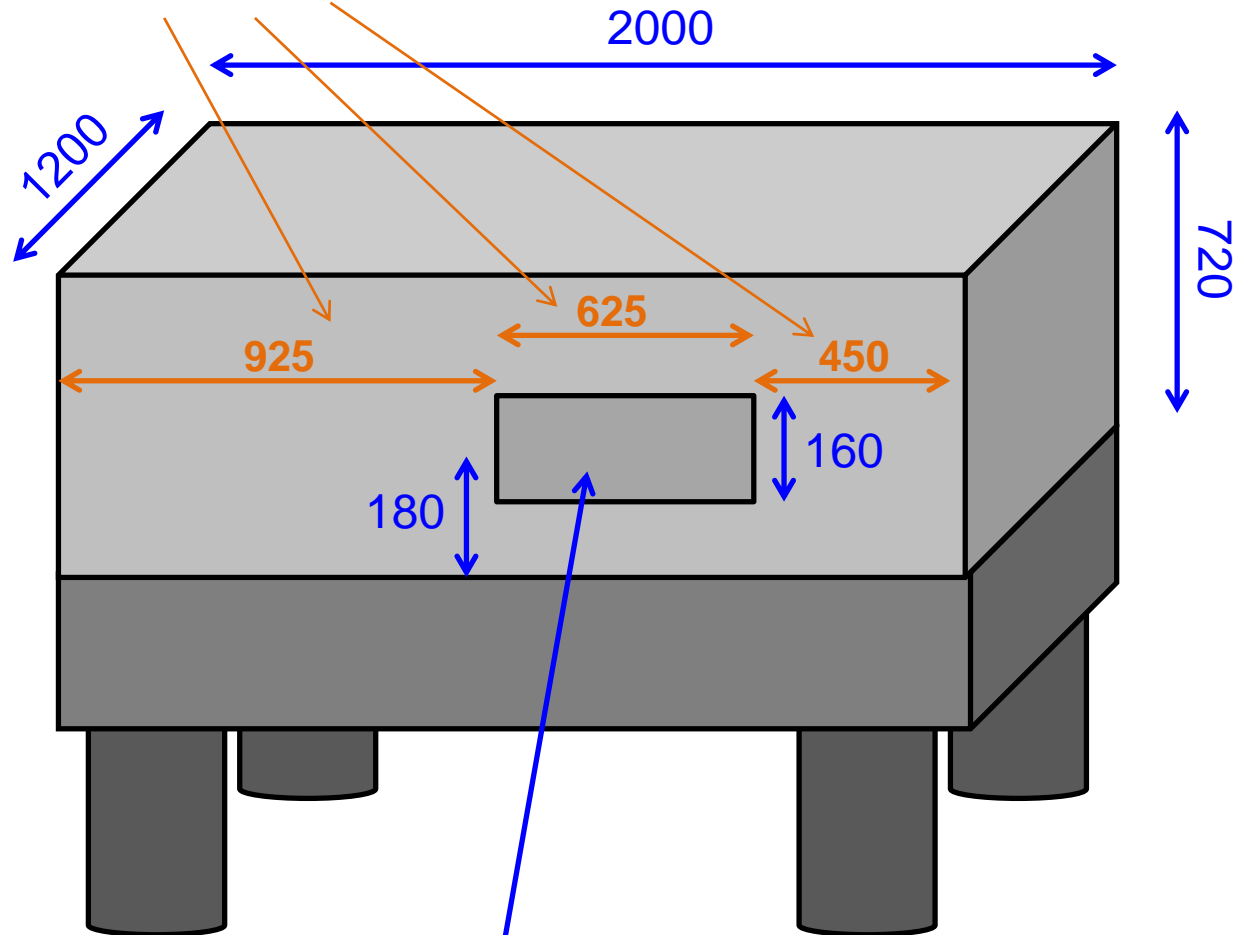

高さ180を中心に高さ160の長方形の穴  
に光路筒を設置

# Chamber and Optical Table

K400-ICF125フランジがつく

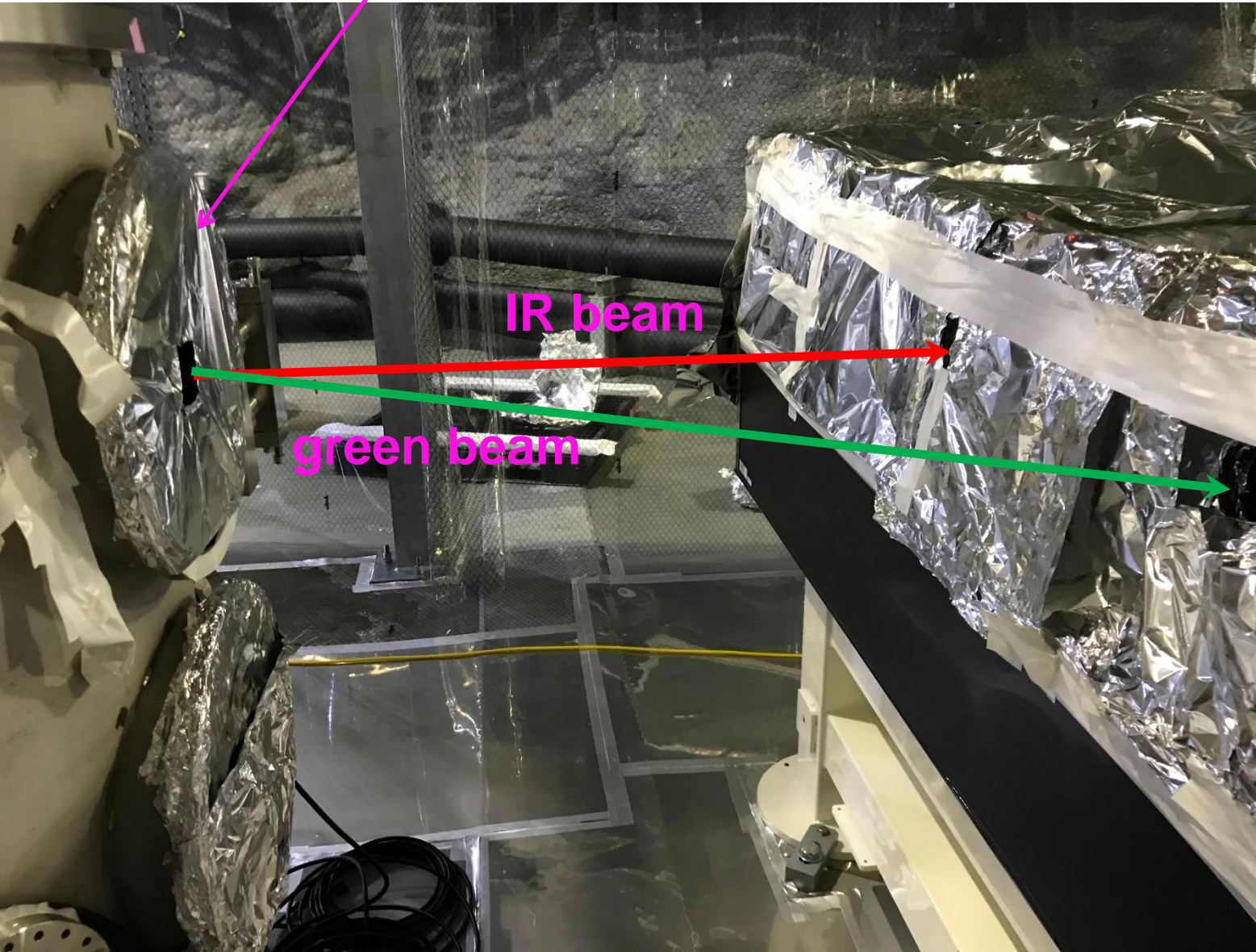

# Optical Table

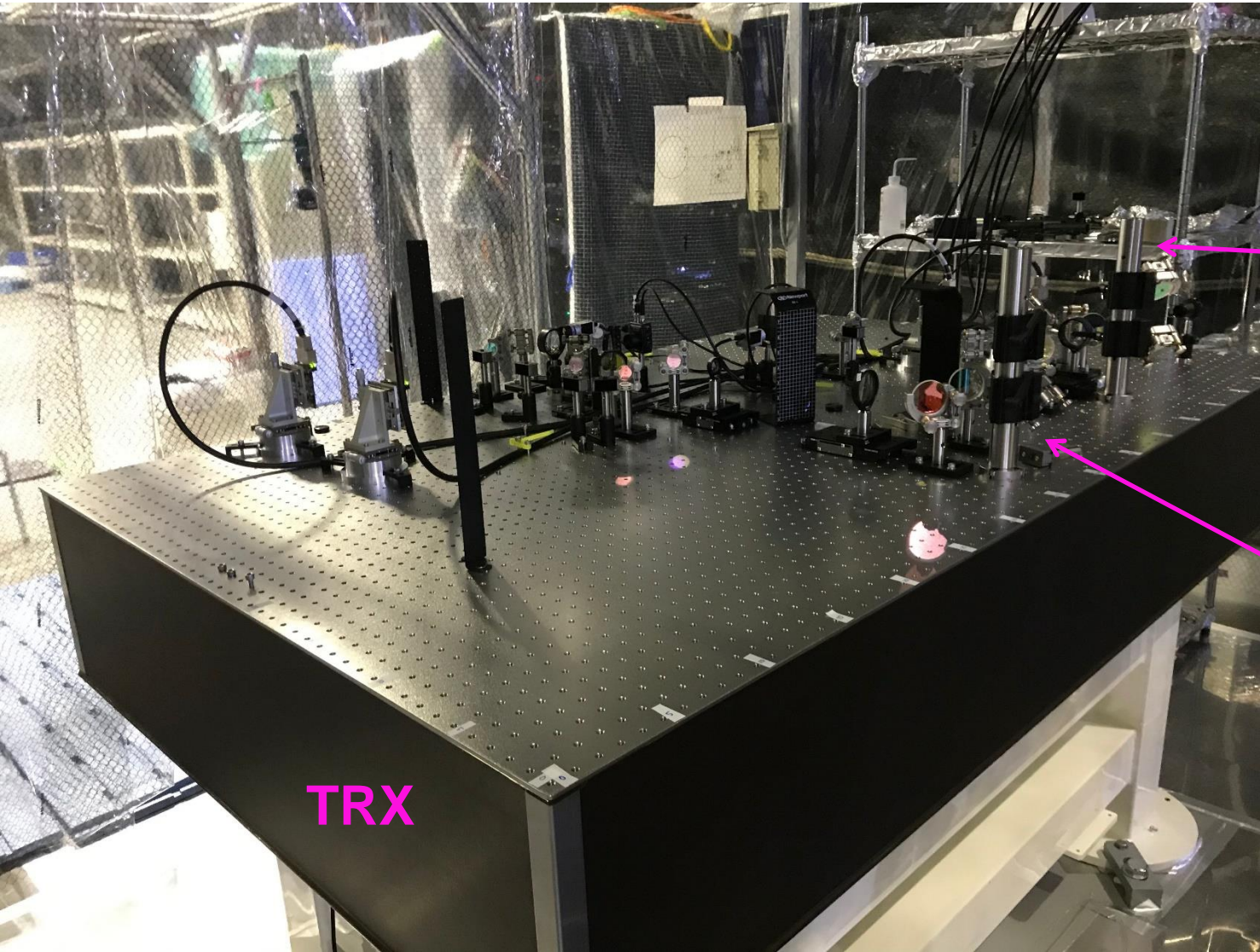

Periscope  
for green

Periscope  
for IR

TRX



# Beam Height

Periscope for IR (~185 mm)

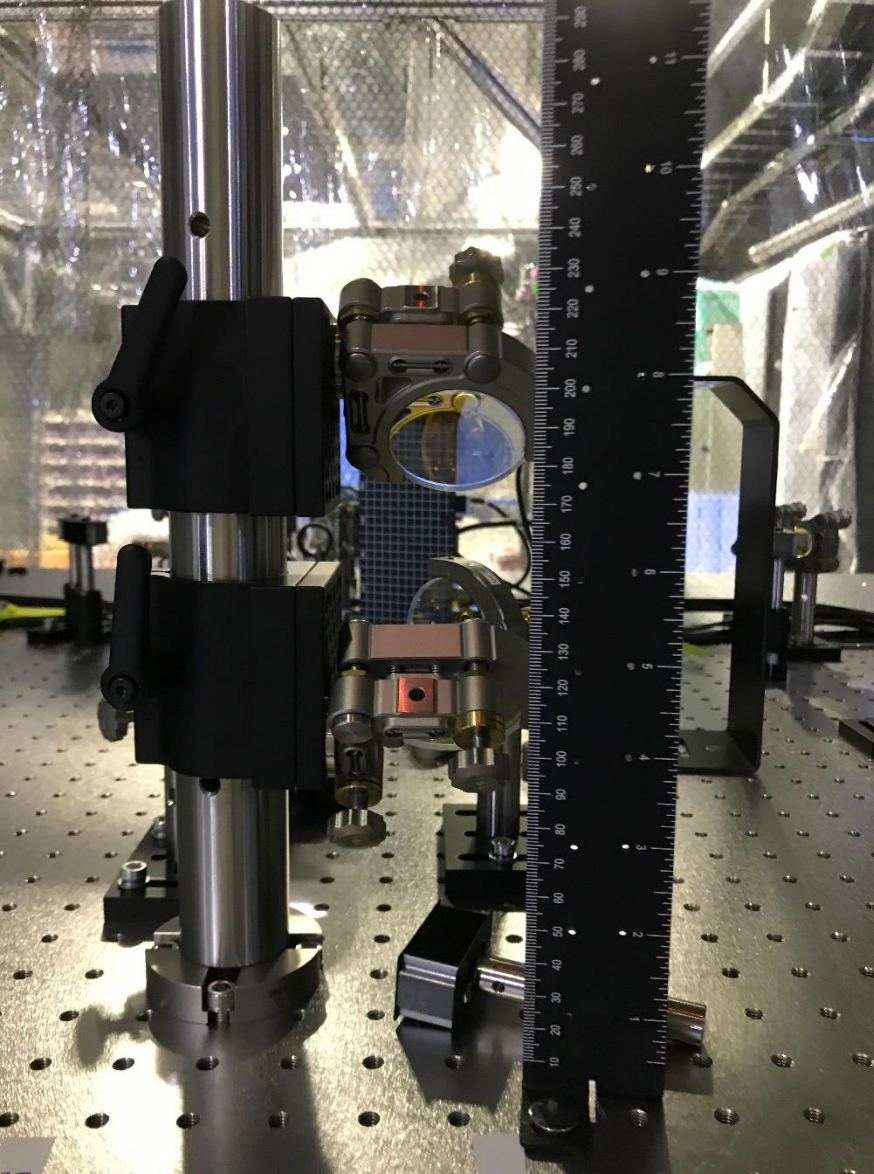

Periscope for green (~180 mm)

