

Procedure of assembly of the payload

JGW-E1503830-v5draft

Fabián Erasmo Peña Arellano

4th October 2015

1 Introduction

This document describes the procedure of hanging the mirror (TM) and the recoil mass (RM) from the intermediate mass (IM). The 3D CAD model used to produce the images was provided by Hirata-san at the following location:

Please note the following:

1. Intermediate mass must be assembled with the exception of few sub-assemblies:
 - a) No OSEM flags.
 - b) Four free threaded holes at the upper side of the IM for attachment of the winch fixture.
 - c) The clamp assemblies at the sides should not have the clamps in position.
2. The recoil mass should be ready with the OSEMs aligned in position. The OSEM bodies should be 6.5 mm from the face of the back ring of the RM.

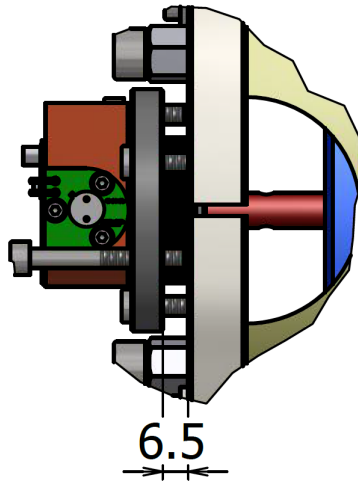

3. There should be a log with the OSEM part number and the position of each OSEM in the RM. Please follow a similar convention to the one used in TAMA.

1 Introduction

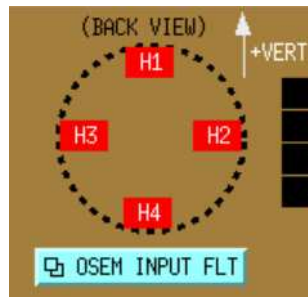

TAMA

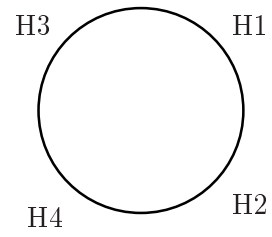

KAGRA

2 Bill of materials

1. $4 \times$ ISO 4762 M6 \times 35 mm surface treated screws.
2. Bubble level.
3. $8 \times$ pins part number ALPSTAG10-L20_0-E2_0-A15. These likely come with the frame.
4. $2 \times$ C-clamps.
5. $4 \times$ M5 \times 45 mm screws.
6. $4 \times$ M5 plain washers.
7. $4 \times$ ISO 4762 M5 \times 30 mm.
8. $4 \times$ ISO 4762 M6 \times 70 mm.
9. $4 \times$ ISO 4762 M12 \times 35 mm screws. These are for the pillars of the earthquake stop at the IM level.

3 Hanging the mirror

1. We begin with the bare frame. Please note the following:
 - The base of the frame has four M6 clear holes at the vertices of a 500×400 mm rectangle. Please use these holes to fix the frame on an optical breadboard or table using $4 \times$ ISO 4762 M6 \times 35 mm surface treated screws (listed in item 1 in Sec. 2).
 - Use a bubble level to level the base of the frame straight. (Item 2 in Sec. 2.)

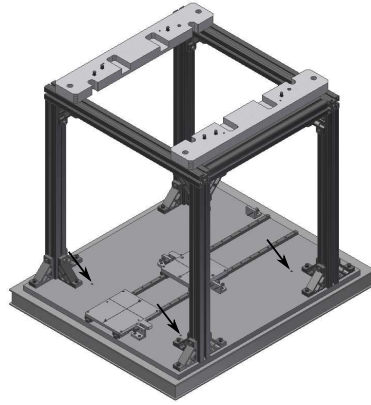

2. Assemble the earthquake stop ring for the IM. Use the following components
3. Place the earthquake stop ring for the IM on the frame. Set it in position using 8 pins which have to be inserted on the frame (item 3 in Sec. 2).

3 Hanging the mirror

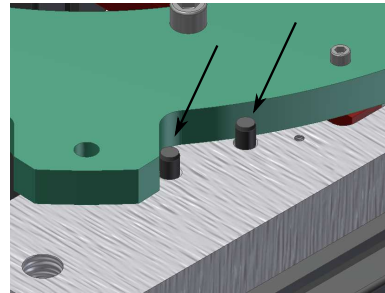
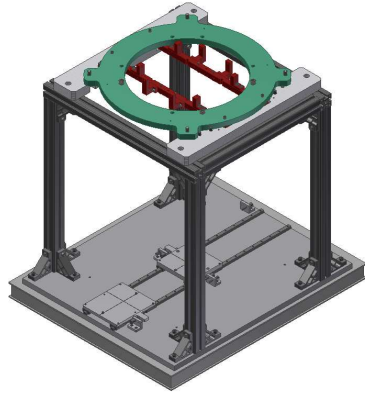

4. Secure the earthquake stop to the frame with two C-clamps as shown in the cross section view.

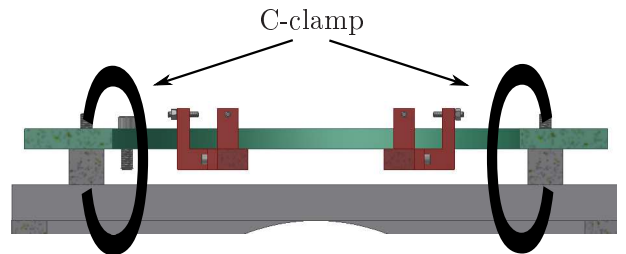
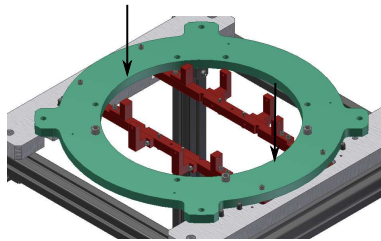

5. Place the IM on top of the earthquake stop. The wire clamps should face the sides of the frame and not to the front or back. Note that since the frame seems to be symmetric (it looks the same whether it's seen from the front or the back), the direction (front or back) from which the optic and RM are inserted will be determined by the orientation of the IM selected now.

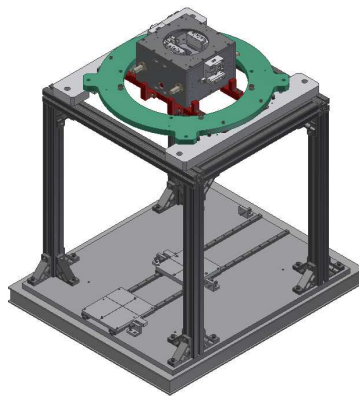

3 Hanging the mirror

6. Secure the IM to the earthquake stop with the following fasteners:

- Screws: $4 \times M5 \times 45$ mm.
- Washers: $4 \times M5$ plain washers.

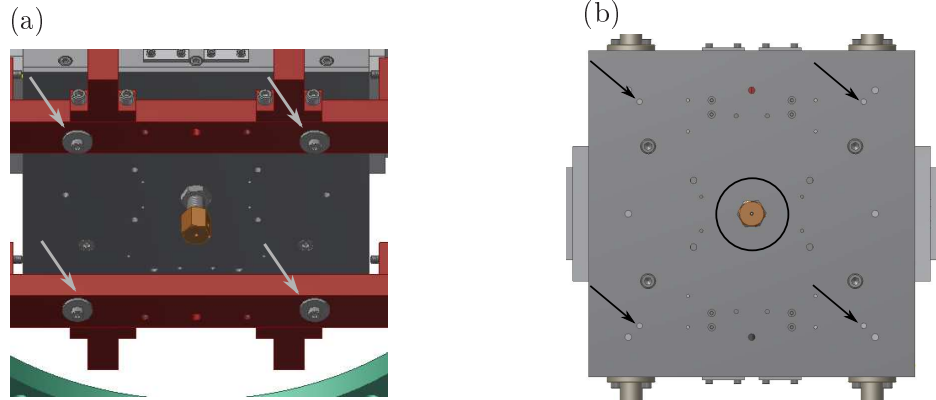

7. Place the winch system on top of the IM. Secure it with the following screws: $4 \times$ ISO 4762 M5 \times 30 mm. Remove any peek cable clamp from the top of the IM and move the cables out of the way.

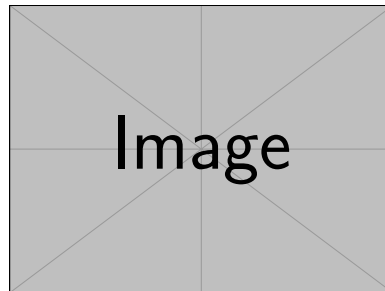

8. Place the bubble level on top of the IM. (The diagram has to be updated.)

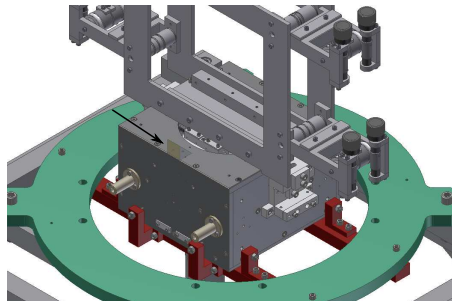

3 Hanging the mirror

9. Release the fasteners tightened in step 6. Adjust the tilt of the IM using the bubble level. Loosen the screws with the washers and adjust the tilt with the four full-threaded screws which are inserted into the crossed beams of the earthquake stop. Once the IM is straight, fasten the screws with the washers to fix it in position. The IM must be 2 mm above the earthquake stop plate and 22 mm above the crossbeam. Use a caliper to measure these quantities. The height of the IM from the base of the frame should be 786 mm. Use a height gauge to measure it. Also check yaw. The full-threaded screws are ISO4762 M6×70 mm. These screws will not remain with the payload within the vacuum chamber during operation.

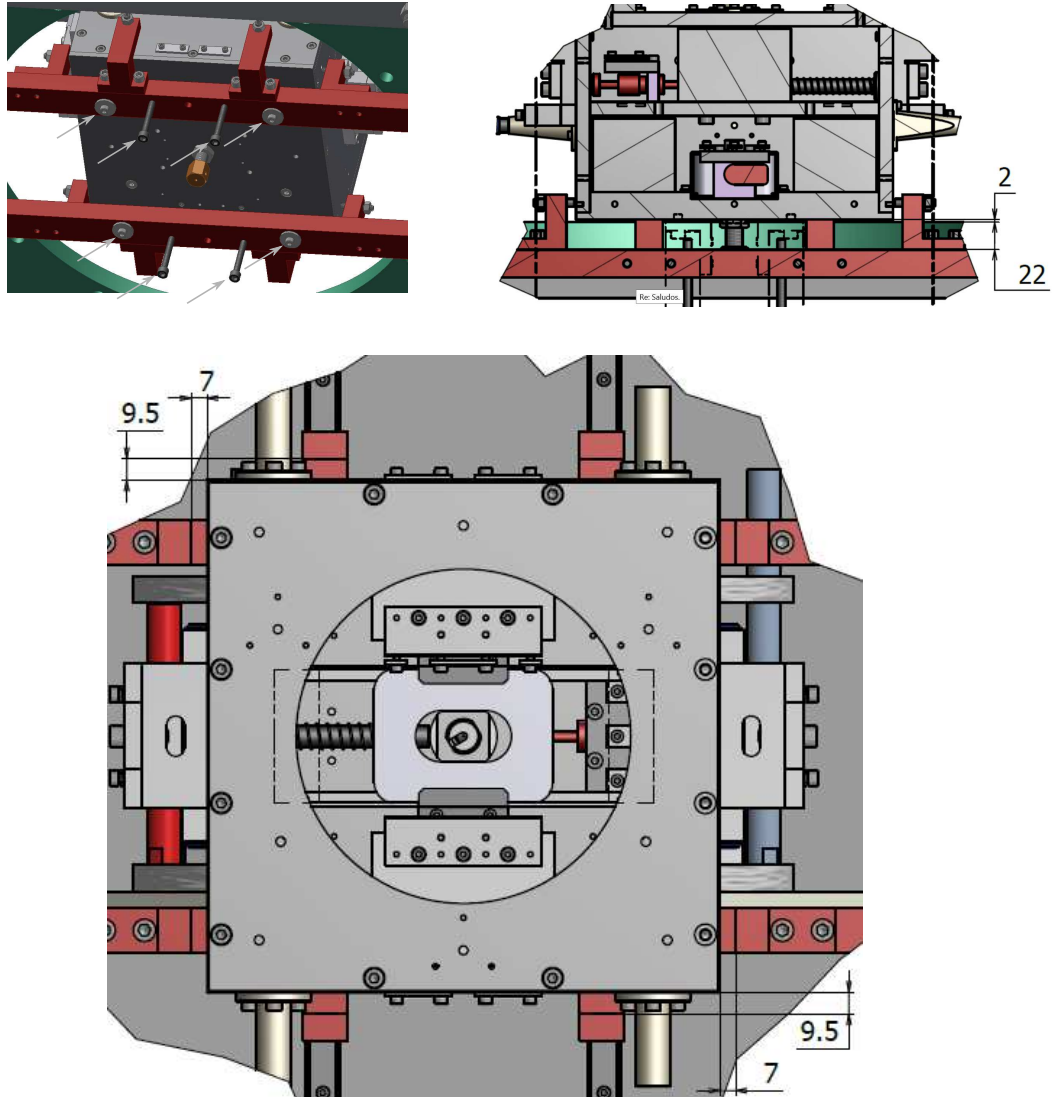

3 Hanging the mirror

10. Hang a plumb-bob from the magnetic damper holder at the bottom of the IM. Slide the base of the mirror support under the IM and place its center where the plumb-bob indicates. Fix it in place with the screws on the sides.

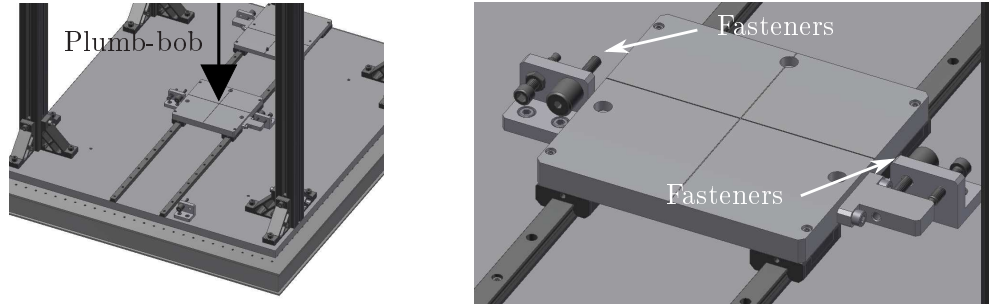

11. Place the case with the mirror inside on the table on the support placed under the IM in the previous step. There are screws to fasten it to the support (the holes are shown in the second drawing in step 10).

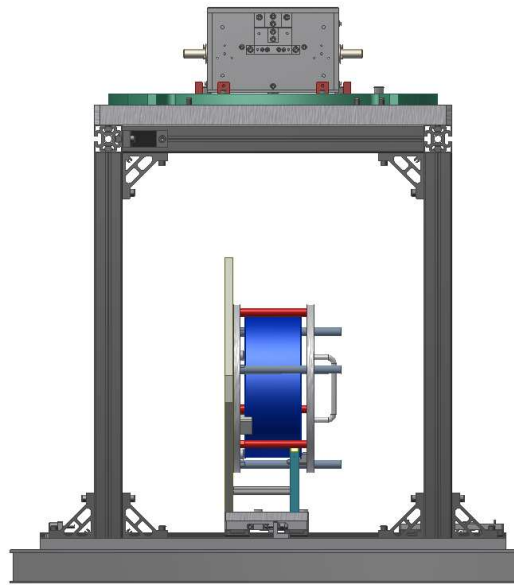

12. Cut two pieces of 2.5 m of 200 μm of piano wire.
13. Wipe with solvents. LIGO used methanol, then acetone and finally isopropanol.
14. Bring one end of each wire underneath the mirror through the hole in the case.

3 Hanging the mirror

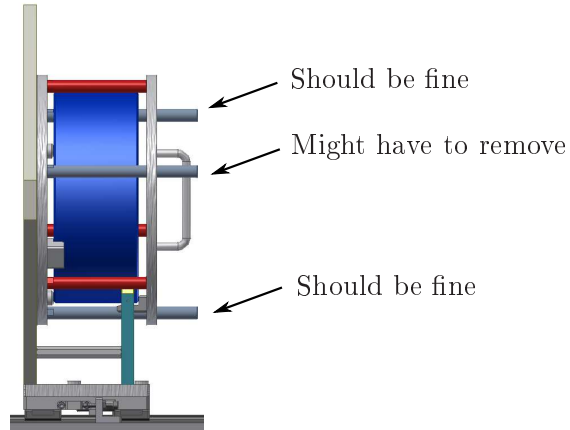

15. Bring the wires through the slits in the clamps all the way up to the winches. One of the gray rods might be on the way of the wires, please remove it.

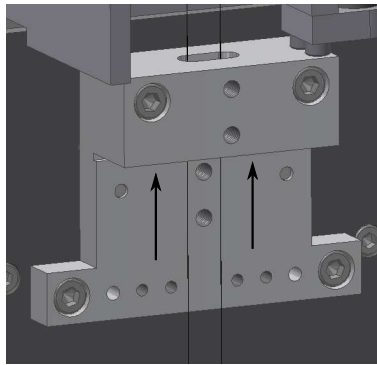

16. Fold the wires over the winch roller with the grooves and bring them to the roller with the clamp and fix them. Clamps referred to as *A* in the figure have grooves on the round face which can be used to host the wires. In order to do this operation more comfortably it is possible to use an auxiliary flat clamp between the two rollers, but release it once the wires are fixed. Such flat clamp is not shown in the figure, but its place is indicated by holes *B* and *C*. Rotate the roller to wind the wire at least one loop. This is to avoid cutting the wire with the clamp. There is at least one person in each group who has used the winches before. (Pictures taken from the e-log entry at <http://www2.nao.ac.jp/~gw-eelog/os1/?r=184>.)

3 Hanging the mirror

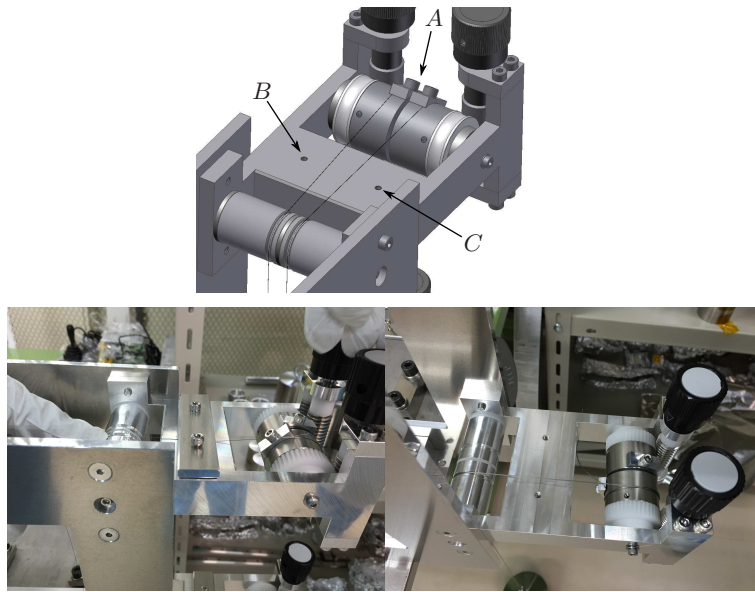

17. Create tension in the pair of wires by pulling them down from below the clamp assembly in the IM and then **softly** fix them with the upper clamp without the vertical grooves.

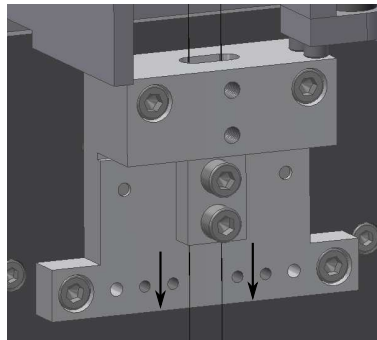

18. At the other side of the payload bring the other two ends of the wires up through the slit in the clamp all the way to the winches.

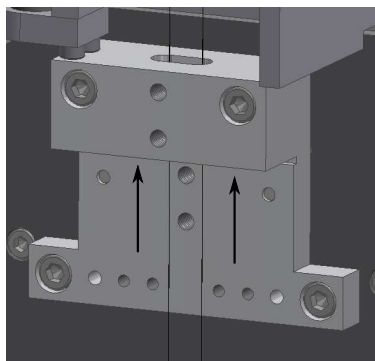

3 Hanging the mirror

19. As in step 16, fold the wires over the winch roller. Before clamping them create tension by pulling them and making sure they go within the grooves of the four wire breakers around the TM. The figure shows one wire breaker and the grooves are clearly seen. Note that in reality the glass beads are not as neatly placed as depicted.

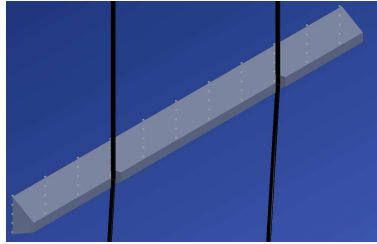

20. Remove or retract any components of the case that would keep the mirror from being lifted slightly. Some of the components don't seem to be removable, but others do. (The model does not have OSEM flags or wire breakers. I has to be updated.)

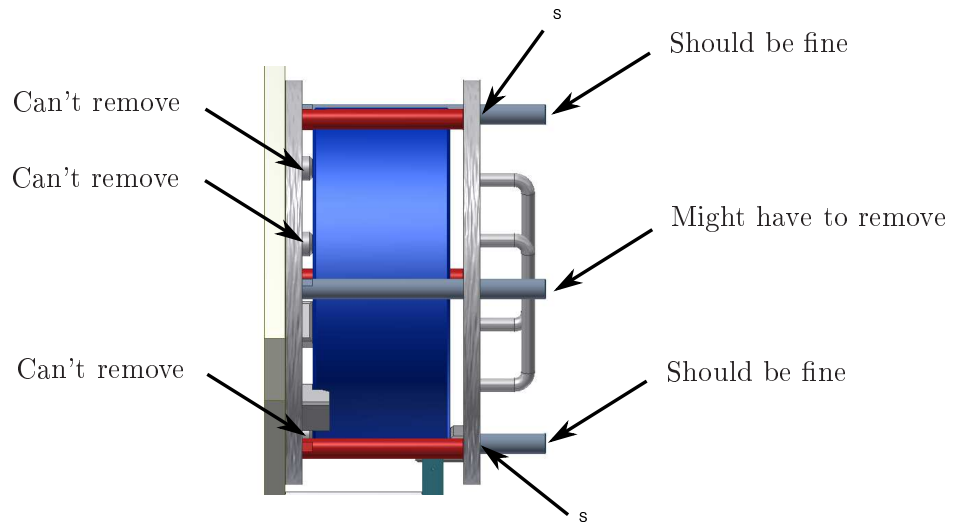

21. Release the clamp adjusted in step 17.
22. Lift the mirror slightly with the wires. Do not go very far up. Move the case to make the optic hang completely free. This will allow us to lift the mirror further and to align it. (The model does not have OSEM flags or wire breakers. I has to be updated.)

3 Hanging the mirror

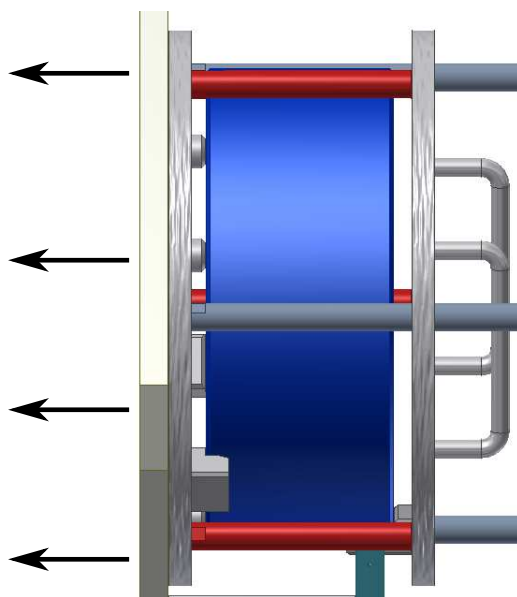

23. Use the four upper knobs to lift the optic 3 mm from their resting position on the support. The height of the wire breakers must be 251 mm after lifting. Use a height gauge. (The model has to be updated.)

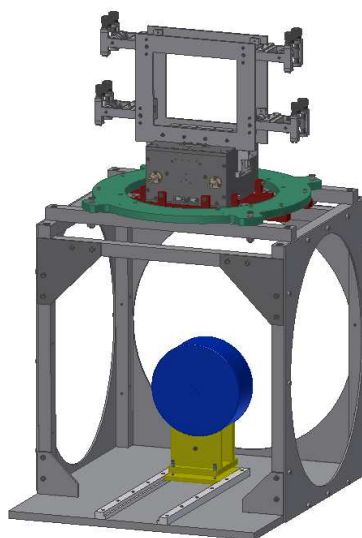

24. Using the knobs also, align the optic with the optical lever.
25. Once the TM is aligned close the lower clamps, which have grooves. Make sure the wires are held within the grooves. Do this on both sides of the IM. **These clamps should not be tightened. They should only be closed gently.** The

3 Hanging the mirror

intention is to produce an elastic deformation of the wires. Use a torque wrench with a TBD torque spec.

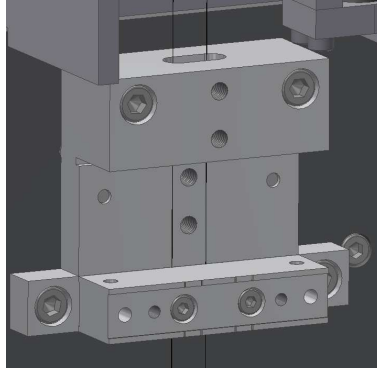

26. Check whether the alignment of the TM changed. In case it did, release the clamps and go back to step 24. Otherwise continue to the next step.
27. Tighten the upper clamps on both sides of the IM. These clamps do not have grooves. The aim is to produce a plastic deformation of the wires in order to hold the mirror.

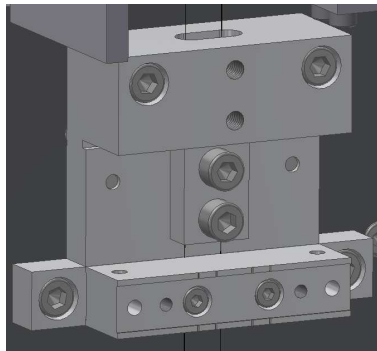

28. Remove whatever is necessary from around the optic in order to bring the RM around it. Put back any gray rod that could have been removed if possible. They are guides to remove the side plate. (The diagram below has to be updated.)

3 Hanging the mirror

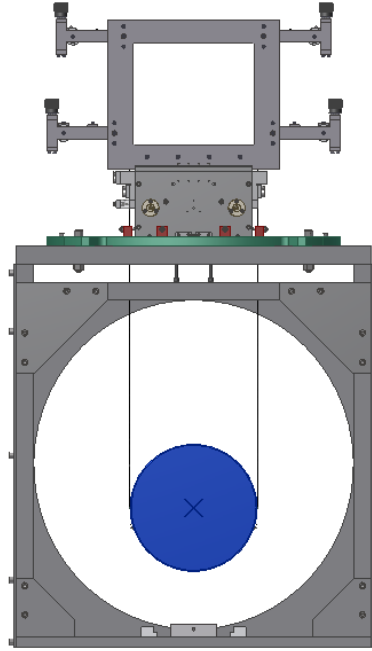

29. Using the gray rods remove the side plate without damaging the OSEM flags.
30. Place the RM with its support on the rails. Adjust the height of the wire breakers to 251 mm above the table with the height gauge.

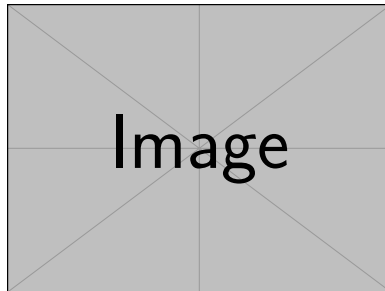

31. Bring the RM as close as possible to the optic without removing the protective case of the optic. Coarsely set the tilt of the RM by adjusting the screws at the base of the support of the RM. A bubble level can be placed on the multipurpose cube. By visual inspection align the OSEM cavities with the flags on the optic.

3 *Hanging the mirror*

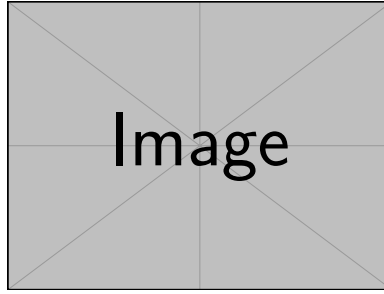

32. Connect the OSEMs to the satellite boxes and obtain a suitable readout. Ideally this should be the digital system. Have the calibration curves of the OSEM ready for inspection. For the test procedure at Kamioka we don't have calibration curves since we're using the prototype satellite boxes from TAMA300. Just check the open voltage output and record it in the log.

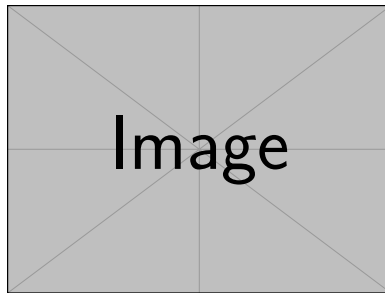

33. Bring the RM around the optic until one or more OSEMs deliver approximately the output expected at the nominal position of the flags. Such voltage would typically be half of the open voltage.

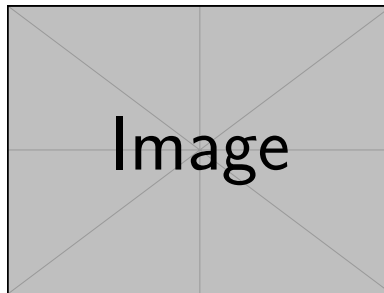

34. Close the RM with the front ring. Do not screw the earthquake stop screws all the way in.

3 Hanging the mirror

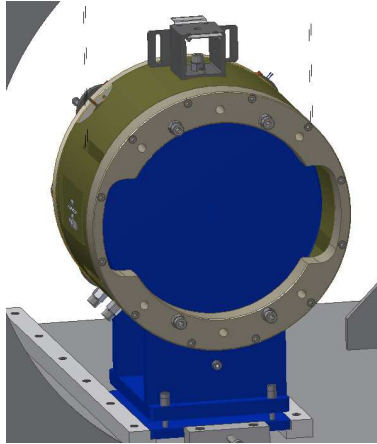

35. Clamp the OSEM ribbon cables on the RM back ring, on the multipurpose cube on top and on the sides of the IM. Use stainless steel clips for the multipurpose cube. From the IM the cables will likely need another temporary anchor point before being connected to the satellite boxes.
36. Cut 2.5 m of 600 μm tungsten wire. We can also try the 650 tungsten μm wire should the wire breaker allow. (I still have to check whether the wire breaker receives it.)
37. Bring the ends of the wires underneath the RM through the hole in the pedestal.

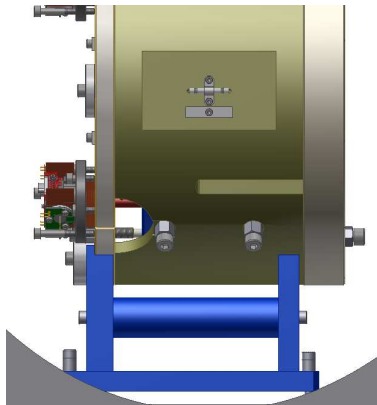

38. On one side of the payload bring the wires in front of the clamps on the IM all the way up to the winches.

3 Hanging the mirror

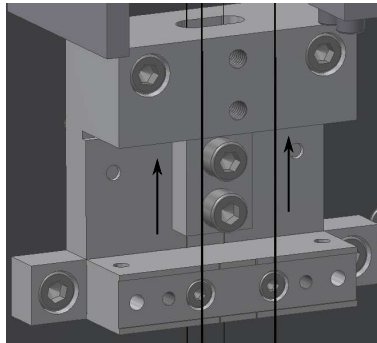

39. Fold the wires over the winch roller with the grooves and bring them to the roller with the clamp and fix them. Use the clamp between the two rollers if necessary but release it once the wire is fixed.

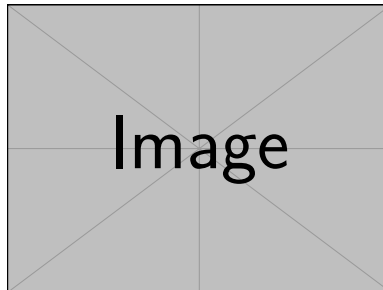

40. Create tension in the pair of wires by pulling them down from below the clamp assembly in the IM and then gently fix them with the upper flat clamp without the vertical grooves. The function of the clamp at this stage is only to keep the tension of the wire above the clamp.

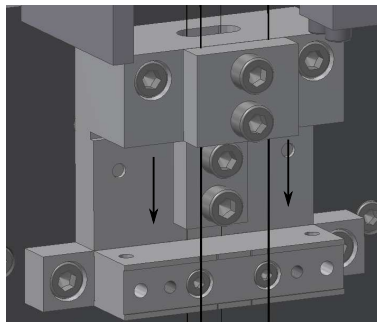

41. At the other side of the payload bring the wires all the way to the winches.

3 *Hanging the mirror*

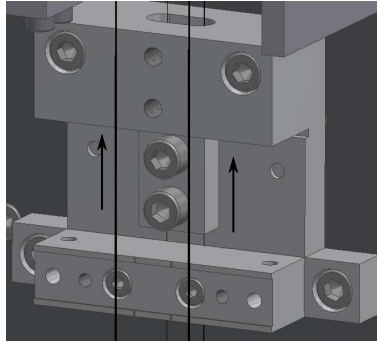

42. Fold the wires over the winch roller with the grooves and bring them to the roller with the clamp. Create tension by pulling the wires up, but not enough that would lift the RM. Make sure the wires go within the grooves of the two wire breakers around the RM. Fix the wires onto the roller with the clamps. Use the flat clamp in between the two rollers if necessary.

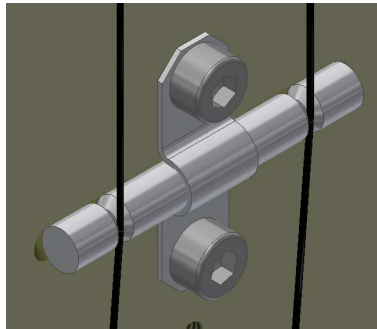

43. Remove any components of the RM support that would keep it from hanging. (As far as I understand, in the current design there is nothing of this sort.)

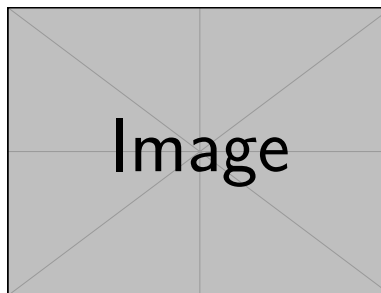

44. Place bubble level on top of the multipurpose cube.

3 Hanging the mirror

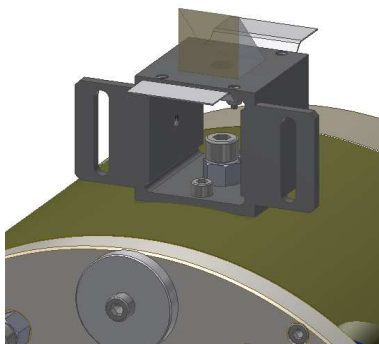

45. Release the clamp adjusted in step 40.
46. Bring down the RM support slowly. Do it while looking at the positions of the flags within the OSEMs. The flags should not come close to the OSEM body. If the RM still comes down with the support increase the tension in the wires by adjusting the knobs of the winches. Bring down the support until the RM hangs.

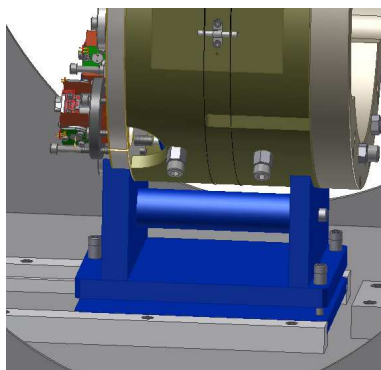

47. Using the knobs align the RM with the optical lever using the reflection on the prism. Do this first in pitch and then in roll by rotating the right angle prism 90 degrees.

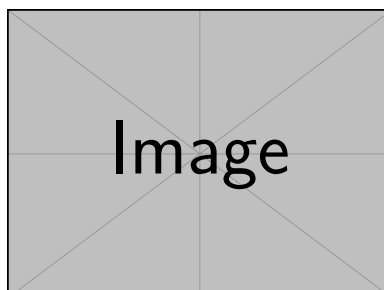

3 Hanging the mirror

48. Measure again the height of the wire breakers. It should be 251 mm.
49. Close the lower clamps, which have grooves, in order to fix the wires in position (20 mm separation). **These clamps should not be tightened strongly, but gently in order to produce an elastic deformation.** [Torque spec TBD](#).

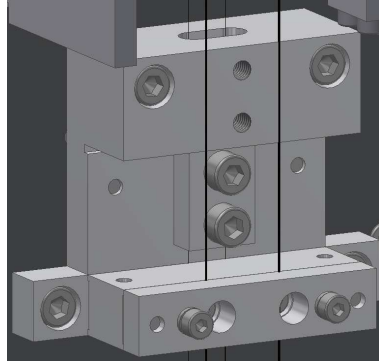

50. Check whether the alignment of the TM changed. In case it did, release the clamps and go back to step 46. Otherwise, continue to the next step.
51. Tighten the upper clamps on both clamp assemblies. [Torque spec TBD](#). These clamps do not have grooves. These clamps are meant to hold the weight of the RM and a plastic deformation of the wires should be achieved.

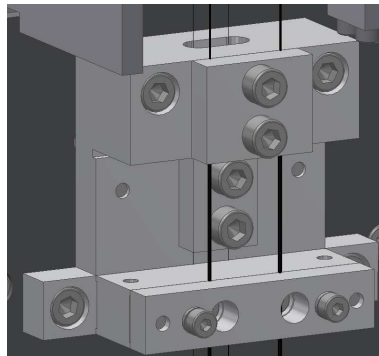

52. Check the output of the OSEMs. Provided the OSEMs were aligned and set at the correct position with respect to the RM, the flags should be close to their nominal positions and the output voltage should be close to 6 V. If they are not then either the OSEMs were not aligned when mounted on the RM or the RM is not aligned with respect to the TM. In the first case please align the OSEMs individually. This may be hard without the lower section of the earthquake stop around the RM. So, the earthquake stop should be assembled now before realignment of the OSEM.
53. The wires can be cut and the winch system can be removed.

3 Hanging the mirror

54. In case the lower section of the earthquake stop was not assembled in step 52, assemble it now.